

# WX24

## Presentation:

The WX24 is public address audio projector prepared for outdoor use.

The aluminum enclosure comprises 2x 4" (0.75in VC) Full range transducers, one placed on each end to make this a bidirectional speaker. There is an integrated 100V 'matching transformer' allowing multiple WX24 to be connected together in high impedance installations.

Power tapping is offered through cable - ABS gland (outdoor use).

Made of lightweight and rugged AL, the WX24 can deliver in any colour (not just black or white) and is supplied with a hanging bracket.

Offering a very clean design this WX24 can use in a wide variety of public address applications, a professional solution for contractors suited for noisy audio installations such as shops, shopping malls, supermarkets, underground stations, car parks, factories, etc.

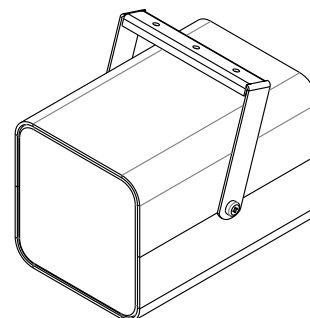

## Features:

- Public address audio projector
- Slim and clean design
- 2x 4" FR EU transducer (bidirectional)
- Suitable for 100V high imp. installations
- Cable gland for outdoor use
- Supplied with hanging bracket
- Rugged AL enclosure
- Powder coated iron mesh grille
- Can supply in colors other than black or white

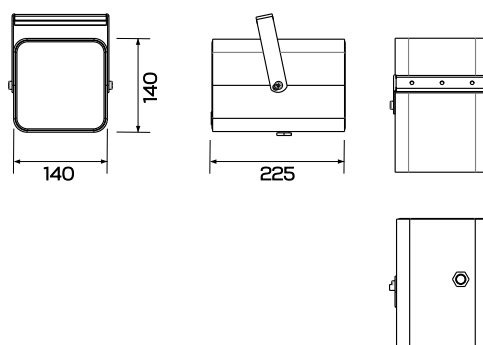

## Technical specifications:

### Acoustical

Type	Full range audio projector
Transducer type	2x 4" FR transducer
	Bidirectional
Power taps (100V)	10W/15W/30W
Frequency range	150Hz - 14kHz
Sensitivity	95dB (1W@1m)
Max. SPL	100dB

### Mechanical

Colour	RAL9016
	Others available upon request
Housing	Aluminum, cable gland
	Suited for outdoor use
Grille	Powder coated iron mesh
Installation	Hanging bracket (supplied)
Dimensions	140x140x225mm
	5.51x5.51x8.86in
Weight	3Kg
	6.61lb

