

WX5

Presentation:

WX5 is an installation speaker designed for shops, galleries, supermarkets and any outdoor venue that achieves excellent results and excellent acoustic performance.

Very versatile, this PA speaker operates both high impedance 70/100V line and 8ohm low impedance applications being adapted to different types of installation. It features a switch to select the power taps (2W, 4W, 8W, 16W and 8ohm). The power tap is selected by rotating the slot of the 5 position rotary switch to the desired tap.

The WX5 integrates a 5.25" LF woofer + 0.5" HF tweeter offering a clear sound for background music at short to medium distances.

Made of ABS (polypropylene) this speaker is IP65 rated.

With a powder coated aluminum grille the WX5 is supplied in pairs, together with its own wall mount brackets for a quick and easy installation. Two colors are available: black (RAL9004) and white (RAL9003).

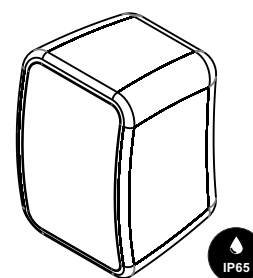

Features:

- Public address installation speaker
- Clean and elegant design
- 5.25" LF + 0.5" HF transducers
- Suitable for 70V & 100V high imp. installations
- Euroblock terminal connection
- Quick mounting system
- Polypropylene housing - IP54
- Powder coated AL grille
- Available in black or white

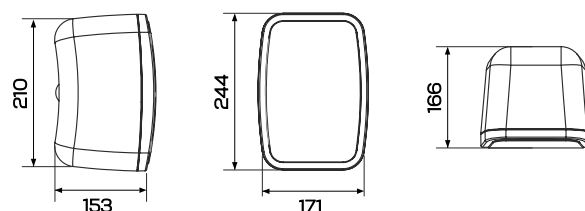

Technical specifications:

Acoustical

Type	2-way Public address speaker
Low impedance power	40W @ 8ohm
Transducer type	5.25" LF + 0.5" HF transducers
Power taps (100V)	16W @ 625 Ohm, 8W @ 1k25 Ohm 4W @ 2k5 Ohm, 2W @ 5 KOhm
Power taps (70V)	8W @ 625 Ohm, 4W @ 1k25 Ohm 2W @ 2k5 Ohm, 1W @ 5 KOhm
Impedance	8Ohm
Frequency range	94Hz - 20kHz
Sensitivity	91dB
Max. SPL	107dB
Dispersion (HxV)	90°x70°

Mechanical

Connectors	Euroblock terminal
Colour	RAL9003 (white), RAL9004 (black)
Housing	ABS (polypropylene)
Grille	Powder coated AL mesh
IP rating	IP65
Mounting accessories	Wall bracket included
Dimensions	171x244x166mm
Weight	2.3Kg

